



Ratchet Repair Kit - 6730

Read, Understand, Follow and Save These Instructions

Read, understand and follow all of these instructions and warnings (Instructions) before installing and using this product. Install and use this product only as specified in these instructions. Improper installation or use of this product may result in property damage, serious injury, and/or death. Never allow installation or use of this product by anyone without providing them with these instructions. You must read, understand and follow all instructions and warnings for any product(s) to which this product is used in conjunction with or installed. Save these instructions with the product for use as a reference for any future installation and use of the product.

⚠ WARNING

Failure to follow these warnings and instructions may result in property damage, serious bodily injury, and/or death.

- Purchaser/owner must ensure that product is installed according these instructions. Purchaser/owner must not alter or modify product.
- Operator and bystanders should never position any part of body under any portion of this product or the load being supported.
- Do not allow children to play on or around this product or the load being supported.
- Never exceed maximum rated capacity. Refer to

stamped markings or decals on product to obtain rated capacity. If uncertain, contact Cequent Performance Products at 1-800-521-0510 or www.cequentgroup.com

- This product rated according to SAE J706
- All welding must be performed by an AWS certified welder.
- Always replace bent, broken, or worn parts before using this product.

- After repair kit installation and prior to use, refer to the instruction sheet of the winch model being used. If instructions are unavailable or you are uncertain, please contact Cequent Performance Products at 1-800-521-0510 or www.cequentgroup.com

Installation Instructions

Warning: Failure to follow these warnings and instructions may result in property damage, serious bodily injury, and/or death.

1. Remove any load on the winch.
2. Before disassembling the ratchet mechanism, study the position of the spring and spacer.
3. Disassemble ratchet assembly by removing locknut. Dispose of all old parts. CAUTION: Do not intermix new and old parts; use all parts supplied in kit. Due to continuous improvements in design, new parts may be different.

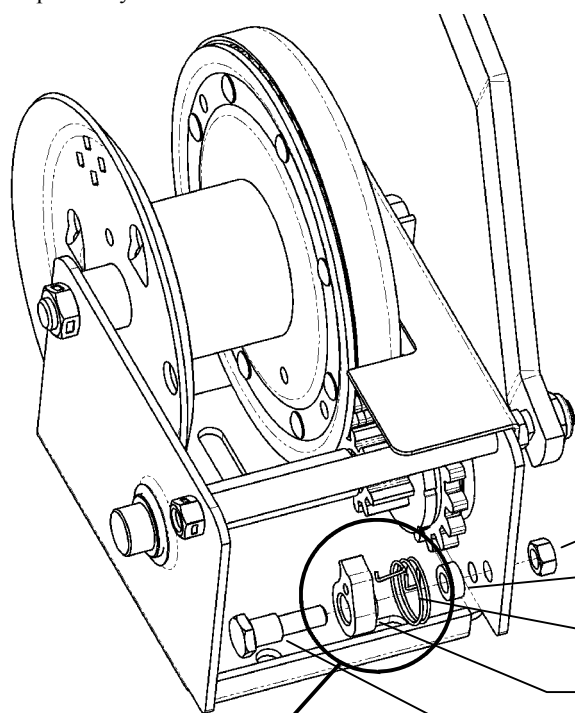

Detail A

4. Insert ratchet spring from the inside of winch frame into the lower hole.
5. Insert the other end of the spring through the small hole in ratchet pawl. Please not that the pointed end of ratchet pawl MUST engage the teeth of the ratchet gear.
6. Insert the shoulder bolt through the large hole in the ratchet pawl and spring, through the spacer and finally through the upper hole in the winch frame.
7. Install locknut onto shoulder bolt and torque to 7 ft.lbs. CAUTION: Do not over tighten the locknut because this will cause the shoulder bolt to tighten against the ratchet pawl and the ratchet pawl will not function properly.
8. Place a drop of oil where the ratchet pawl pivots on shoulder bolt.
9. Make final test by turning the winch handle clockwise. Ratchet must make a clicking sound whenever the handle is turned clockwise, and not clicking when turned counter-clockwise. CAUTION: It is unsafe to use if ratchet is not functioning properly.

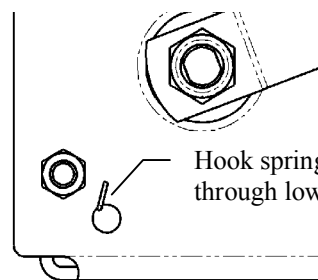

Hook spring through lower hole

Locknut

Spacer

Ratchet Spring

Ratchet Pawl

Shoulder Bolt

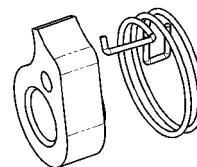

Detail A

Spring & Pawl Configuration

How to Order

Use only Cequent Performance Products' parts or parts of equal quality for repair. Replacement parts are available through Cequent Performance Products' Customer Service Department, 1-800-521-0510. Please specify product model number.

CEQUENT PERFORMANCE PRODUCTS, INC.

F2061 [rev A (PCN13287)]

Plymouth, MI 48170 USA
800/521-0510
www.cequentgroup.com