



Gooseneck Coupler Set-Bolt Kit

Read, Understand, Follow and Save These Instructions

Read, understand and follow all of these instructions and warnings (Instructions) before installing and using this product. Install and use this product only as specified in these instructions. Improper installation or use of this product may result in property damage, serious injury, and/or death. Never allow installation or use of this product by anyone without providing them with these instructions. You must read, understand and follow all instructions and warnings for any product(s) to which this product is used in conjunction with or installed. Save these instructions with the product for use as a reference for any future installation and use of the product.

! WARNING

Failure to follow these warnings and instructions may result in property damage, serious bodily injury, and/or death.

- Purchaser/owner must ensure that product is installed according to these instructions. Purchaser/owner must not alter or modify product.
- Operator and bystanders should never position any part of body under any portion of this product or the load being supported.
- Do not allow children to play on or around this product or the load being supported.
- Never exceed maximum rated capacity. Refer to stamped markings or decals on product to obtain rated capacity. If uncertain, contact Ceqent Performance Products at 1-800-521-0510 or www.cequentgroup.com
- All welding must be performed by an AWS certified welder.
- Always replace bent, broken, or worn parts before using this product.
- Only a qualified technician using professional equipment are to be used for this installation.

Installation Instructions

Warning: Failure to follow these warnings and instructions may result in property damage, serious bodily injury, and/or death.

Fig. 1

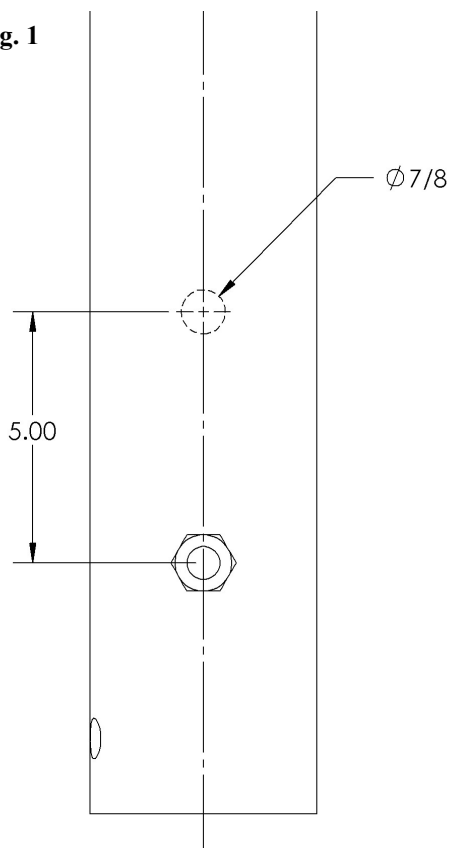

1. Properly support the trailer and chock wheels.
2. Loosen set-bolt, remove support pin and carefully lower inner tube/coupler assembly from the outer tube.
3. Locate the new hole on centerline of the outer tube and 5" up from the center of the existing weld nut (Fig. 1).
4. Make a 7/8" diameter hole through one side only.

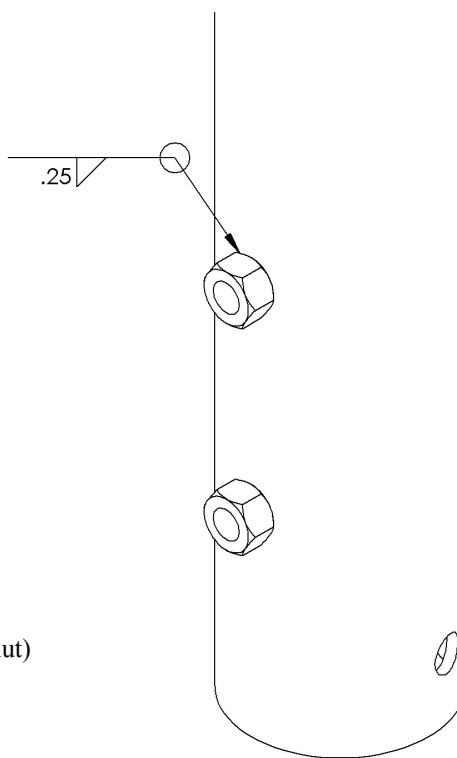

Fig. 2

5. Using a 1/4" weld, attach the heavy-hex nut (not the thin jam-nut) to the tube by welding completely around the nut (Fig. 2).
6. After the weld has cooled, run a 3/4-10 tap through the nut and hole in tube.
7. Reassemble the inner tube/coupler assembly, support pin and install set-bolts/jam nuts.
8. Torque set-bolts to a minimum 125 ft-lbs and tighten jam nuts.

CEQUENT PERFORMANCE PRODUCTS, INC.

Plymouth, MI 48170 USA
800/521-0510
www.cequentgroup.com

F3798 (rev A-16015)