

INSTALLATION INSTRUCTIONS

58425 BASE RAIL MOUNTING KIT

FORD F-150 & F-250 THROUGH '96 / '97 F-250 OVER 8500 GVW, F350 THROUGH '97 / 1999 & NEWER F-250 / F-350 & F-450 SUPERDUTY PICKUPS (Not Cab-On-Chassis)

DEALER/INSTALLER:

- (1) Provide this Manual to end user.
- (2) Physically demonstrate procedures in this Manual to end user.
- (3) Have end user demonstrate that he/she understands procedures.

END USER:

- (1) Read and follow this Manual every time you use Hitch.
- (2) Save this Manual for future reference.
- (3) Pass on copies of Manual to any other user or owner of Hitch.

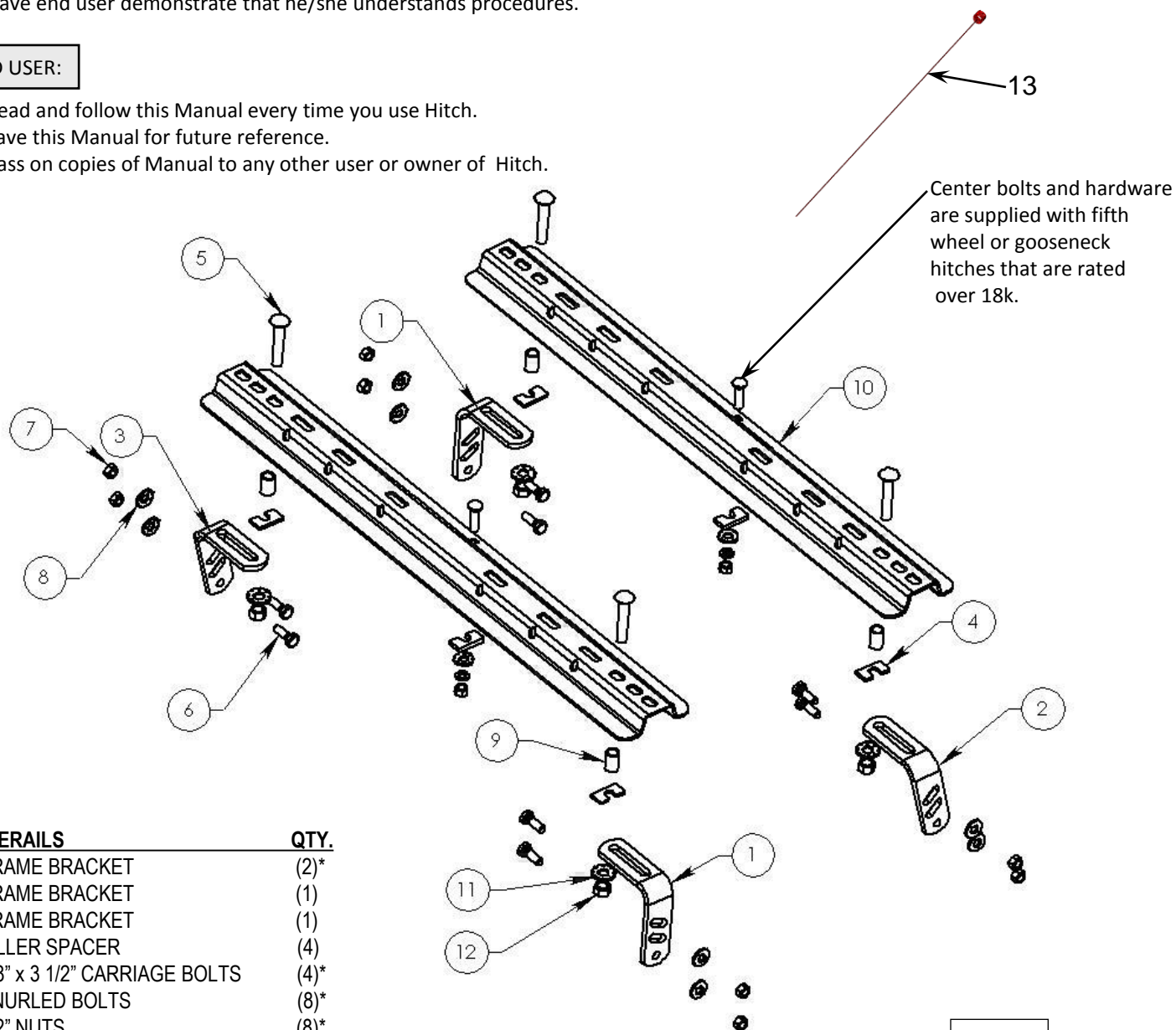

BASERAILS	QTY.
1. FRAME BRACKET	(2)*
2. FRAME BRACKET	(1)
3. FRAME BRACKET	(1)
4. FILLER SPACER	(4)
5. 5/8" x 3 1/2" CARRIAGE BOLTS	(4)*
6. KNURLED BOLTS	(8)*
7. 1/2" NUTS	(8)*
8. 1/2" SERRATED WASHERS	(8)*
9. TUBE SPACER	(4)*
10. BASE RAILS	(2)*
11. 5/8" SERRATED WASHERS	(4)*
12. 5/8" NUTS	(4)*
13. 1/2" PULL WIRE	(4)*

* Parts supplied with 30095

Fig. 1

NOTE: NOT ALL HARDWARE IS GOING TO BE USED ON ALL INSTALLATIONS

For Installation Assistance or Technical Help, Call 1-888-521-0510

GENERAL INSTRUCTIONS FOR 30035 BASE RAIL INSTALLATION

TOOLS

3/16" drill
17/32" drill
"C" Clamps

3/4" Socket & Open End Wrench
100 lb-ft Torque Wrench

15/16" Socket & Open End Wrench
21/32" drill

1. The following instructions should be used to mount the 5th wheel. Care and attention to detail will ensure a quick quality installation. Check parts against parts list to become familiar with parts in kit. (See Fig. 1)
2. Raise rear of truck high enough to allow jack stands to be placed under rear spring hanger bracket of truck. This will provide maximum room to install the 5th wheel brackets.



WARNING:

If the truck is raised, be sure that the truck is properly blocked and restrained to prevent the truck from falling. Failure to do so may result in the truck suddenly falling, causing death or serious injury.

3. Do not install mounting rails over plastic bed liners. Plastic bed liners must be cut out of the way. Base rails may be installed on spray in liner. **Note:** Consult installer for recommended curing time.
4. Use only CEQUENT PERFORMANCE PRODUCTS supplied bolts, nuts, and washers to install this kit. All bolts are grade 5 and nuts are grade 5 unless specified otherwise.
5. Specific instructions for most commonly used vehicles are included. If these instructions do not apply to your vehicle, be sure that each end of each base rail is connected to the vehicle frame. Each frame bracket must be bolted to the vehicle frame with two bolts, unless optional weld is used.



CAUTION:

These instructions are guidelines only. Actual installation is the responsibility of the installer and the owner. Always measure truck and trailer before installing hitch to be sure that there is clearance at the cab and at the bumper to allow for turns.

To prevent the trailer from hitting the cab with the trailer turned 90°, the center of the hitch should be at least 52" from the back of the cab when using a long bed truck. (Actual distance required will depend on trailer width and king pin location.) Short bed trucks (Minimum 38" from back cab to axle center line) require a minimum of a 13" extended pin box with a Kwik slide or a SIDEWINDER Pinbox Coupler for regular maneuvers. **DO NOT INSTALL ON OR ATTEMPT TO TOW WITH A TRUCK HAVING LESS THAN A 6' BED WITHOUT A SIDEWINDER PINBOX COUPLER INSTALLED ON THE TRAILER.**

6. Measurements are given from Rear Edge of truck bed to rear edge of the base rail closest to the Rear Edge of truck for most vehicle applications. (See Fig. 3)
7. Center hitch between fender wells and make sure rails are square. Adjust position of rails until both diagonal measurements are the same. This should allow installation of a gooseneck or other 5th wheels to these rails.

Fig. 2

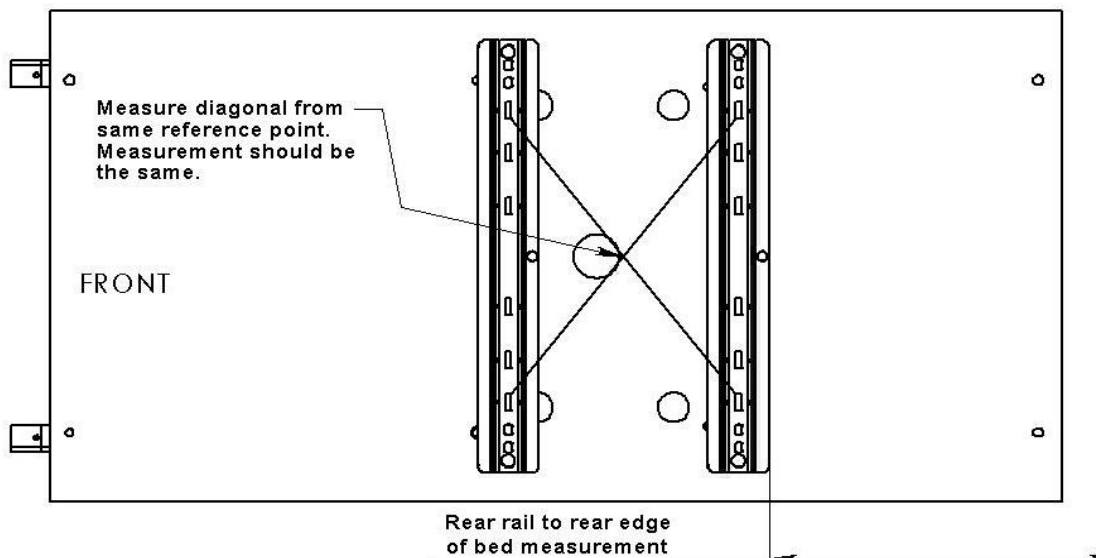

For Installation Assistance or Technical Help, Call 1-888-521-0510

**CAUTION:**

Check for obstructions before drilling. Failure to do so could result in damaged fuel or brake lines, structural members, etc. CEQUENT PERFORMANCE PRODUCTS does its best to communicate tow vehicle manufacturer changes; however, it is ultimately the responsibility of the installer to prevent damage due to installation.

8. Mark 4 holes on the truck bed, using whichever one of the three 5/8" slots at each end of the rail that line up best with the frame mounting brackets below. (Hole location will vary for individual vehicle applications.) Drill all holes with 3/16" drill and enlarge them with a 21/32" drill. Always use sharp drill bits. A 3/16" pilot hole will greatly speed drilling larger holes. Install tube spacer between rail and bed, install 5/8" carriage bolts into holes. Install filler spacer above or below bed to fill corrugations in bed floor. Install serrated washers and nuts.

9. Install mounting brackets onto carriage bolts. Use the left and right angled frame brackets at locations where frame obstruction will not allow the frame brackets to be positioned. Secure bolts through mounting brackets with serrated washers, hex nuts. (SEE FIG. 4)

10. Drill two 17/32" holes in truck frame for each frame bracket. Select the holes which will give the greatest spread between bolts. Install eight 1/2"-13x1-3/8" ribbed neck bolts, (threads pointing out), serrated washers, and hex nuts. Tighten nuts until bolt heads seat. Lubrication of knurls of all rib neck bolts is recommended.

Note: On vehicles with heavy duty suspensions, check for interference with bolts where brackets are mounted to frame. If interference with suspension spring results, cut bolt flush to nut outboard of frame or use weld option.

**WARNING:**

DO NOT lubricate threads. It may cause bolt failure.

**CAUTION:**

Check for obstructions before drilling. Failure to do so could result in damaged fuel or brake lines, structural members, etc. TOWING PRODUCTS does its best to communicate tow vehicle manufacturer changes; however, it is ultimately the responsibility of the installer to prevent damage due to installation.

**CAUTION:**

It is important that 17/32" drill be used for holes in chassis frame as rib neck bolts may break if too small a hole is used and neck may not grip if too large a hole is used.

11. Torque all 1/2" nuts to 85 lb-ft and all 5/8" nuts to 120 lb-ft.

12. Pull wire provided to pull rib neck bolts through frame as needed per application.



CAUTION!



Read pages 2-5 of these instructions before starting installation. Failure to do so could result in significant vehicle damage!

IMPORTANT NOTES FOR THIS INSTALLATION:

1. On Drivers side install straight bracket at forward rail and the angled bracket at rear rail (angle bracket should be pointing rearward). Bolt drivers side rear bracket to frame in top two holes. (See Fig. 4)
2. On Passengers side install the angled bracket at front rail (angle bracket should be pointing rearward) and the straight bracket at the rear rail. Bolt passengers side front bracket to frame in top two holes. (See Fig. 4)
3. May need to move base rail location +/- 1/2" to ensure frame brackets do not interfere with bed sills.

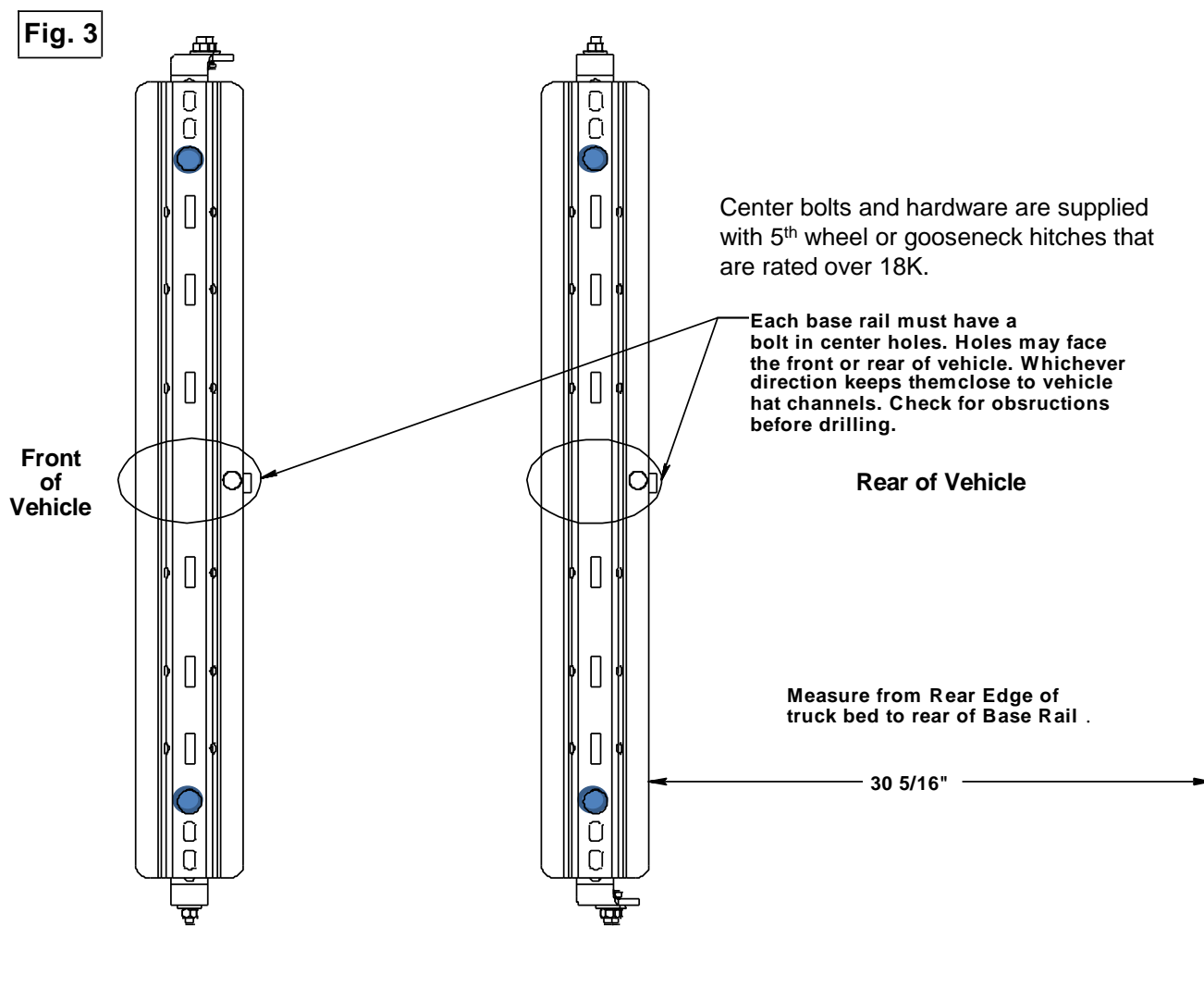

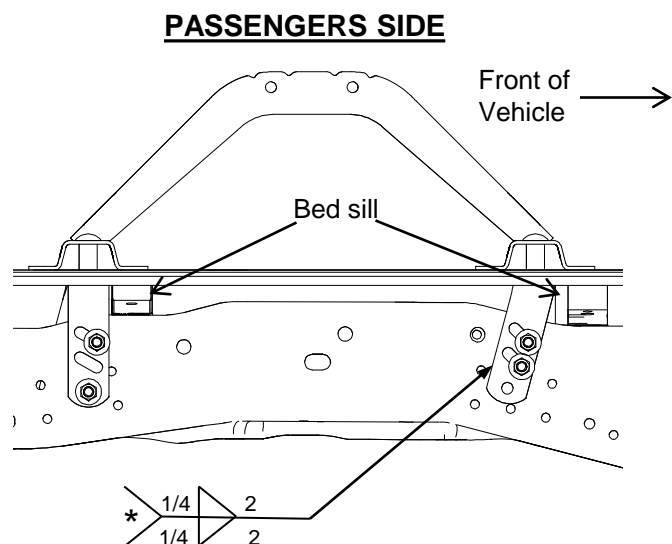
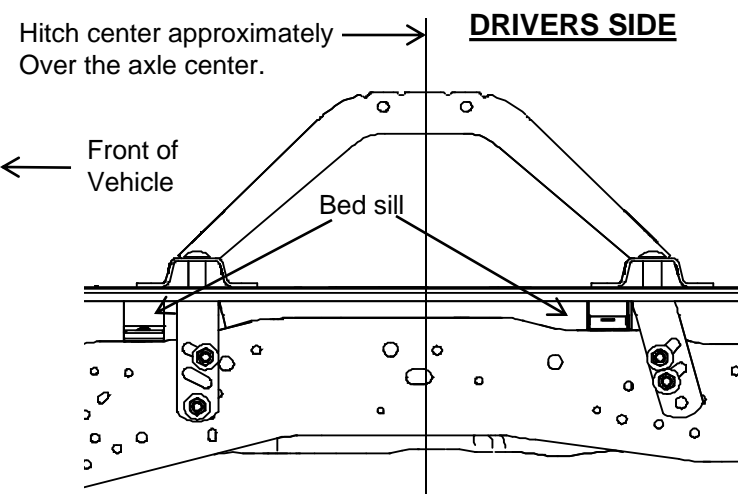

THREE YEAR LIMITED WARRANTY

CEQUENT PERFORMANCE PRODUCTS warrants its 5th Wheel Hitch Mounting Kits from date of purchase against defects in material and workmanship under normal use and service, ordinary wear and tear excepted, for 3 years of ownership to the original consumer purchaser when a TOWING PRODUCTS mounting kit is used.

CEQUENT PERFORMANCE PRODUCTS will replace FREE OF CHARGE any part which proves defective in material or workmanship when presented to any CEQUENT PERFORMANCE PRODUCTS dealer, CEQUENT PERFORMANCE PRODUCTS Warehouse or returned to factory. TRANSPORTATION CHARGES PREPAID, at the address below. THIS WARRANTY IS LIMITED TO DEFECTIVE PARTS REPLACEMENT ONLY. LABOR CHARGES AND/OR DAMAGE INCURRED IN INSTALLATION OR REPLACEMENT AS WELL AS INCIDENTAL AND CONSEQUENTIAL DAMAGES CONNECTED THEREWITH ARE EXCLUDED.

Some states do not allow the exclusion or limitation of incidental or consequential damages, so the above limitation or exclusion may not apply to you.

Any damage to the 5th Wheel Hitch as a result of misuse, abuse, neglect, accident, improper installation, or any use violative of instructions furnished by us, WILL VOID THE WARRANTY.

This warranty gives you specific legal rights, and you may also have other rights which vary from state to state. In the event of a problem with warranty service or performance, you may be able to go to a small claims court, or a federal district court.

Cequent Performance Products, Inc.
47912 Halyard Dr. Suite 100
Plymouth, MI. 48170